

Wire Cable Reel

The wire cable reel offers 2.5 metres of extension. A 2.2mm galvanised steel wire with nylon covering and low gradient residually stressed power spring.

This standard option has many applications, used in the assistance of door opening in tube trains and lifts through to counterbalancing of hospital x-ray equipment.



2540mm of 1.65 diameter 4x7 galvanised steel wire nylon covered 2.62 o/d.

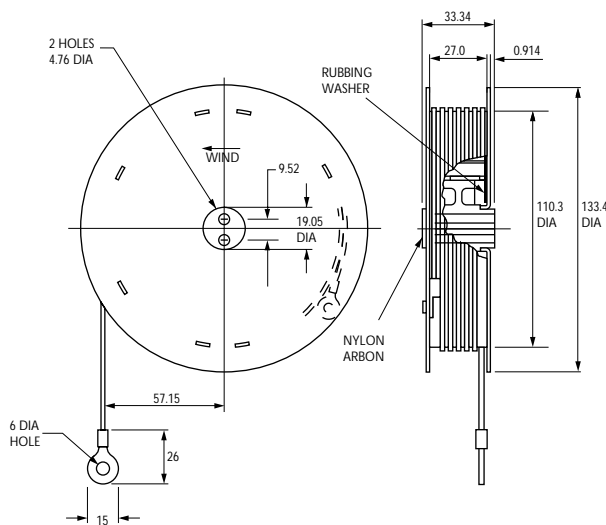

If reel rewinds out of control the spring will slip its fixing on arbor, be undamaged and re-connect on subsequent rewind. Spring is not annealed at end and winds onto a large arbor (44.45 dia.).

